

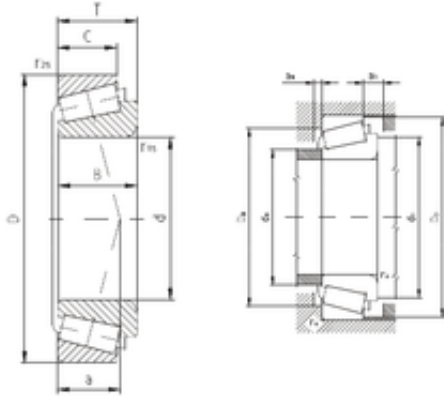

OF Bearing Industrial Co.,Ltd.

ZVL 33010A tapered roller bearings



Bearing No. 33010A

Size	50x80x24 mm
Bore Diameter	50 mm
Outer Diameter	80 mm
Width	24 mm
d	50 mm
D	80 mm
T	24 mm
B	24 mm
C	19 mm
a	17 mm
r1 min.	1 mm
r2 min.	1 mm
da max	56 mm
Da min	72 mm
Da max.	74 mm
db min	56 mm
Db min.	76 mm
ra max.	1 mm
Weight	0,459 Kg
Basic dynamic load rating (C)	75 kN
Basic static load rating (C0)	114 kN
(Grease) Lubrication Speed	4 300 r/min
(Oil) Lubrication Speed	5 600 r/min
Calculation factor (e)	0,32
Calculation factor (Y)	1,9

33010A Bearing 2D drawings and 3D CAD models