

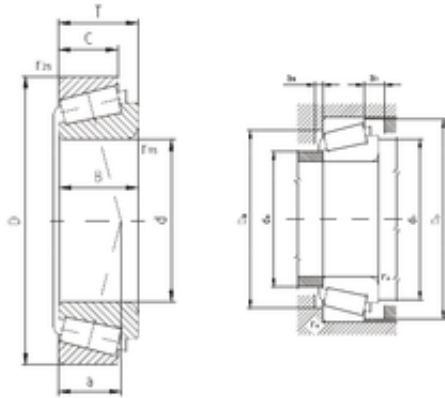

OF Bearing Industrial Co.,Ltd.

ZVL 33211A tapered roller bearings



Bearing No. 33211A

Size	55x100x35 mm
Bore Diameter	55 mm
Outer Diameter	100 mm
Width	35 mm
d	55 mm
D	100 mm
T	35 mm
B	35 mm
C	27 mm
a	26 mm
r1 min.	2 mm
r2 min.	1,5 mm
da max	62 mm
Da min	85 mm
Da max.	90 mm
db min	64 mm
Db min.	96 mm
ra max.	1,5 mm
Weight	1,21 Kg
Basic dynamic load rating (C)	137 kN
Basic static load rating (C0)	196 kN
(Grease) Lubrication Speed	3 600 r/min
(Oil) Lubrication Speed	4 800 r/min
Calculation factor (e)	0,4
Calculation factor (Y)	1,5

33211A Bearing 2D drawings and 3D CAD models