

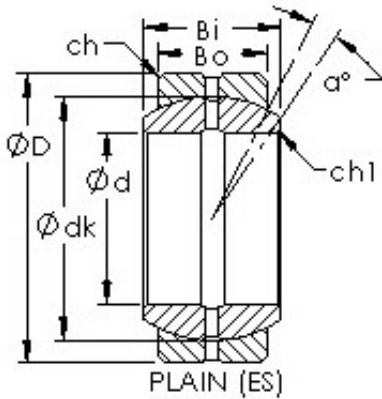

OF Bearing Industrial Co.,Ltd.



AST GEGZ139ES plain bearings

Bearing No. GEGZ139ES

Bore Diameter	139,7 mm
Outer Diameter	222,25 mm
Bearing Type	plain
Bore Dia (d)	5.5000
Outer Dia (D)	8.7500
Outer Width (Bo)	4.1250
Inner Width (Bi)	4.9500
Dynamic Load Rating (Cr)	388,895
Static Load Rating (Cor)	1,168,933
Max. shaft corner radius, or 45 deg. chamfer (ch1)	0.040
Max. housing corner radius, or 45 deg. chamfer (ch)	0.040
Spherical Diameter (dk or Dk)	8.150
Mis-alignment Angle (a deg.)	9
Weight (g)	20,400.00
Material	52100 Chrome steel, or equivalent

GEGZ139ES Bearing 2D drawings and 3D CAD models