

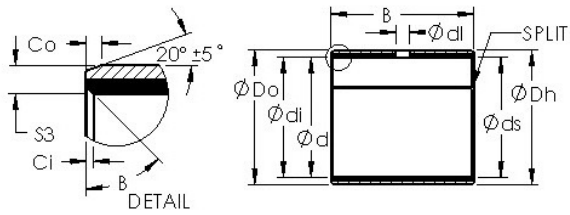

# OF Bearing Industrial Co.,Ltd.



## AST AST50 04IB06 plain bearings

Bearing No. AST50 04IB06

Bore Diameter	6,35 mm
Bearing Type	straight
Shaft Dia., Nominal (d)	0.2500
Shaft Size (ds) - 0.249	0.2481
Housing Bore Dia. (Dh) - 0.3128	0.3122
Bearing Bore after Mounting (di) - 0.2518	0.2492
Average Clearance (Cd)	0.0019
Wall Thickness (S3)	0.032
Bearing Length, Nominal (B)	0.375
Bearing Length Tolerance (B tol.) - +.010 / -0.010	+0.010 / 0.010
OD Chamfer Length (Co)	0.019
ID Chamfer Angle (B deg.)	30
ID Chamfer Length (Ci)	0.010
Material	Carbon steel shell with PTFE / Fiber lining

AST50 04IB06 Bearing 2D drawings and 3D CAD models