

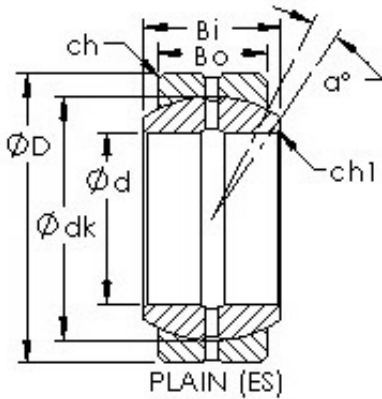

# OF Bearing Industrial Co.,Ltd.



## AST GEZ95ES plain bearings

Bearing No. GEZ95ES

Bore Diameter	95,25 mm
Outer Diameter	149,225 mm
Bearing Type	plain
Bore Dia (d)	3.7500
Outer Dia (D)	5.8750
Outer Width (Bo)	2.8120
Inner Width (Bi)	3.2810
Dynamic Load Rating (Cr)	175,340
Static Load Rating (Cor)	530,516
Max. shaft corner radius, or 45 deg. chamfer (ch1)	0.040
Max. housing corner radius, or 45 deg. chamfer (ch)	0.040
Spherical Diameter (dk or Dk)	5.394
Mis-alignment Angle (a deg.)	6
Weight (g)	5,800.00
Material	52100 Chrome steel, or equivalent

GEZ95ES Bearing 2D drawings and 3D CAD models