

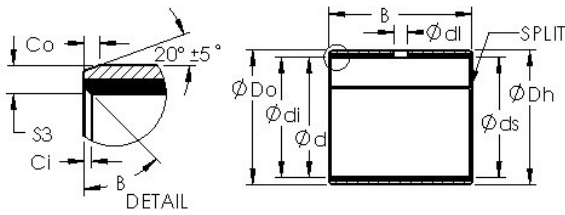

OF Bearing Industrial Co.,Ltd.



AST AST40 4520 plain bearings

Bearing No. AST40 4520

Bore Diameter	45 mm
Outer Diameter	50 mm
Bearing Type	straight
Shaft Dia., Nominal (d)	45.0000
Shaft Size (ds) - 45 -0.025 / -0.050	45 0.025 / 0.050
Housing Bore Dia. (Dh)	50 +0.025 / +0
Bearing Outside Diameter, Nominal(Do)	50.000
Bearing Outside Diameter Tolerance (Do tol.)	50.085 / 50.045
Bearing Bore after Mounting (di)	45.105 / 44.99
Average Clearance (Cd)	0.0850
Wall Thickness (S3)	2.505
Bearing Length, Nominal (B)	20.000
Bearing Length Tolerance (B tol.) - +0 / -0.40	+0 / 0.40
OD Chamfer Length (Co)	1.200
ID Chamfer Angle (B deg.)	45
ID Chamfer Length (Ci)	0.500
Material	Steel shell with PTFE / Polymer Fiber lining

AST40 4520 Bearing 2D drawings and 3D CAD models